

**THE IMPROVEMENTS OF
PROCTOR ROAD
FROM REDWOOD ROAD TO CAMINO ALTA MIRA
CASTRO VALLEY, ALAMEDA COUNTY, CALIFORNIA
SPECIFICATION NO. 2491**

This addendum is issued by the County of Alameda, Public Works Agency, Construction and Development Services Department, 399 Elmhurst Street, Hayward, CA 94544.

TO ALL PROSPECTIVE BIDDERS for the above project, notice is hereby given that the following changes, modifications, corrections, clarifications, and additions as hereinafter set forth shall apply to the plans and specifications described herein and shall be made part thereof and subject to all requirements as if originally specified or drawn.

Receipt of this Addendum No. 2 must be acknowledged on the form in the bid proposal in writing.

CHANGES TO THE PROJECT SPECIFICATIONS

1. Replace Table of Contents page iii with iii (Addendum 2)
2. Replace Project Specification page 669 with attached Project Specification page 669 (Addendum 2)
3. Add Information Handout K: 78-4.09 ARCHITECTURAL TREATMENT (VENEER) (Addendum 2)

CHANGES TO THE PROJECT PLANS

1. Replace Plan Sheet 4 with the attached Plan Sheet 4 (Addendum 2)

END OF ADDENDUM NO. 2
OFFICE OF THE COUNTY ENGINEER

REVISED STANDARD SPECIFICATIONS WITH SPECIAL PROVISIONS – TABLE OF CONTENTS

Information Handout E: Sample Temporary “No Parking” Sign.....i

Information Handout F: Sustainable Design Guide Project Checklisti

Information Handout G: Construction and Demolition Debris Form.....i

Information Handout H: ACPWA Standard Detailsi

Information Handout I: Caltrans Standard Plansi

Information Handout J: Phase II Soils Report.....i

Information Handout K: 78-4.09 ARCHITECTURAL TREATMENT (VENEER) (Addendum 2)....i

78-4.08C(2) Traffic Signal Faces and Fittings

Finish the interiors of the metal signal visor, louver, and the front face of backplates with 2 applications of lusterless black, exterior-grade, latex paint formulated for application to properly prepared metal surfaces. Painting is not required if the equipment has a good factory finish.

Apply 2 coats of lusterless dark olive green, exterior-grade, latex paint formulated for application to properly prepared metal surfaces to the following electrical equipment:

1. Signal section
2. Signal head mounting, brackets and fittings
3. Outside of visor
4. Pedestrian push button housing
5. Pedestrian signal section and visor
6. Back face of back plate

The color must match color chip no. 68 filed at METS.

78-4.08D Payment

Not Used

78-4.09 ARCHITECTURAL TREATMENT (VENEER) – See Information Handout**78-4.~~10~~–78-4.15 RESERVED****78-5 PARKING BUMPERS****78-5.01 GENERAL****78-5.01A Summary**

Section 78-5 includes specifications for constructing parking bumpers.

Section 90 does not apply to concrete for parking bumpers.

78-5.01B Definitions

Reserved

78-5.01C Submittals

Submit product data for parking bumpers.

78-5.01D Quality Assurance

Reserved

78-5.02 MATERIALS

Parking bumpers must be steel-reinforced PC units. The concrete must be air entrained and have a minimum compressive strength of 4,000 psi.

Each unit must be from 4 to 6 inches high, from 6 to 9 inches wide, and from 6 to 8 feet long. All units for a project must be the same size.

Each unit must have chamfered corners, transverse drainage slots on the underside, and at least 2 factory-formed or drilled vertical holes through the parking bumper for anchoring it to the substrate.

The units must be free of pockets, sand streaks, honeycombs, and other obvious defects. Corners must be uniform, straight, and sharp.

The mounting hardware must be galvanized steel.

78-5.03 CONSTRUCTION

Verify that pavement is in suitable condition to start installation under the manufacturer's instructions.

Start installation only after unsatisfactory conditions have been corrected.

Install parking bumpers under the manufacturer's instructions.

**Information Handout K: 78-4.09 ARCHITECTURAL TREATMENT (VENEER)
(Addendum 2)**

INFORMATION HANDOUT K

78-4.09 ARCHITECTURAL TREATMENT (VENEER)

78-4.09A General

78-4.09A(1) Summary

Section 78-4.09 includes specifications for applying architectural treatment (veneer) to the face of retaining walls.

The architectural veneer must be applied to all exposed faces of new CMU retaining walls from top of wall to finish grade, unless otherwise noted on the plans.

Anti-graffiti coating must comply with section 78-4.06.

78-4.09A(2) Definitions

Reserved

78-4.09A(3) Submittals

Submit manufacturer's product data, installation instructions, anchor details, and general recommendations for each specified miscellaneous product, including grout and other finishing materials.

Prepare a ten-square-foot sample of the stucco at the site for County's approval. Once the sample has been approved, meet or exceed that quality of finish in all subsequent work. The sample may be prepared in an inconspicuous location as reviewed by the Owner's Representative.

Provide sample finishes on the actual surfaces to receive stucco to verify appearance. Approved samples will become the standard for the work.

78-4.09A(4) Quality Assurance

Unless otherwise shown or specified, all materials and methods must conform to the appropriate current sections of:

1. California Lathing and Plastering Association.
2. Applicable ASTM Specifications as they reasonably apply to this work, except for measurement and payment requirements.

78-4.09B Materials

Mortar must comply with ASTM C-270, Type S, using ASTM C-150, Type I Portland Cement, in the following proportions:

1. Cement: 1 part
2. Hydrated lime or lime putty: 1/4 to 1/2 parts
3. Aggregate: 2-1/4 to 3 times the volume of cement and lime

Grout must attain a 28-day minimum compressive strength of 2,000 psi, and must be composed of one part low alkali Portland cement, 2-1/4 to 3 parts sand, and 1 to 2 parts 3/8 inch maximum size pea gravel, to which not more than 1/10 part of lime must be added. Sufficient water must be added to produce consistency for pouring without segregation of the constituents of the grout. Combined aggregate volume must be not more than 4 times that of the cement and lime.

Acrylic Priming Agent must be Omegaflex Base Primer, available from Omega Products International, Inc. at (800) 600-6634, or approved equal.

Acrylic Stucco Finish must be Akrotique Finish, available from Omega Products International, Inc. at (800) 600-6634, or approved equal. Finish Coat must be Akrotique fine finish, 01 Cigar, or approved equal.

Plasticizers can be a special finishing hydrated lime complying with ASTM C206, Type S.

Water must be fit to drink.

INFORMATION HANDOUT K

Aggregates must comply with ASTM C144. Sand must conform to the following aggregate gradation:

<u>Sieve Size No.</u>	<u>% Passing Each Sieve</u>
<u>4</u>	<u>100</u>
<u>8</u>	<u>100</u>
<u>16</u>	<u>60-90</u>
<u>30</u>	<u>35-70</u>
<u>50</u>	<u>10-30</u>
<u>100</u>	<u>0-5</u>

The aggregate must not have more than 50% retained between any two consecutive sieves nor more than 25% between the No. 50 and No. 100 sieves.

Concrete Sealer must be a flat finish, clear drying product conforming to ASTM D2939, ASTM D466, ASTM E96, ASTM 836, SS-W-110C.

78-4.09C Construction

Apply stucco only when atmospheric temperature is above 50 degrees F and there is no precipitation.

Apply acrylic base primer only when atmosphere and surface temperature is between 40 and 90 degrees F.

Apply concrete sealer only when surface is dry and atmosphere temperature is 40 degrees F or above.

Inspect masonry wall surfaces for suitability for application of stucco: joints struck flush, no dust, grease, moisture, paint or other substance present detrimental to good bonding.

Check wall for suction appropriate for application of stucco. Do not proceed with installation work until unsatisfactory conditions are corrected.

Take all steps necessary for protection of existing improvements. Promptly remove plaster from other surfaces not to be plastered.

Stucco:

1. Base coat: One part Portland cement, 0-3/4 parts lime and 3-1/4 - 4 parts sand. Apply to a thickness of 1/2 inch.
2. Primer: Acrylic priming agent. Apply to manufacturer's specifications.
3. Finish coat: Acrylic stucco finish. Apply to manufacturer's specifications. Combined thickness of base coat, primer, and finish coat layer 1 and finish coat layer 2 shall be 3/4 inches.
4. Curing: Newly applied stucco shall be kept moist with a fog spray of water for a period of 48 hours from time of application. Minimum allowable curing time between base coat and primer shall be 7 days. Minimum allowable curing time between primer and finish coat shall be 48 hours.

Apply concrete sealer per plans by low-pressure spray with low delivery and light to medium saturation. Do not atomize. Do not soak. Apply an even blanket mist.

Keep exposed work clean as the work progresses, taking care to prevent mortar staining of the block and surrounding construction.

78-4.09D Payment

Payment for anti-graffiti coating is included in the payment for architectural treatment (veneer).

CONSTRUCTION	REVIEWED BY:	DATE:	REVIEWED BY:	DATE:
MAINTENANCE				
REAL ESTATE				

A:\V-TD\Projects\CA\CPWA\2020\207065CA.01\Proctor Road East\Sheets - Consor\02-SWPPP-Proct East_Addendum 2.dwg 4-22-25 09:11:41 AM

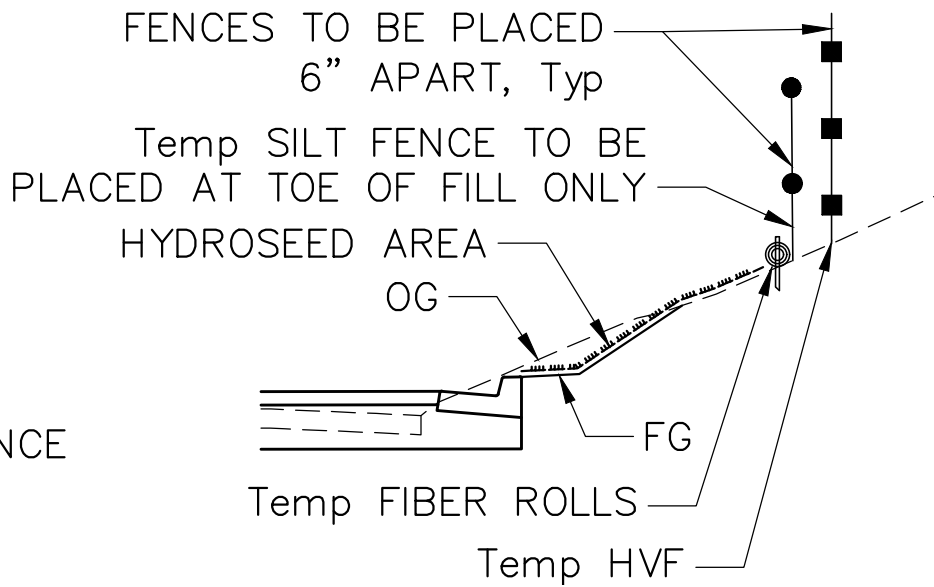
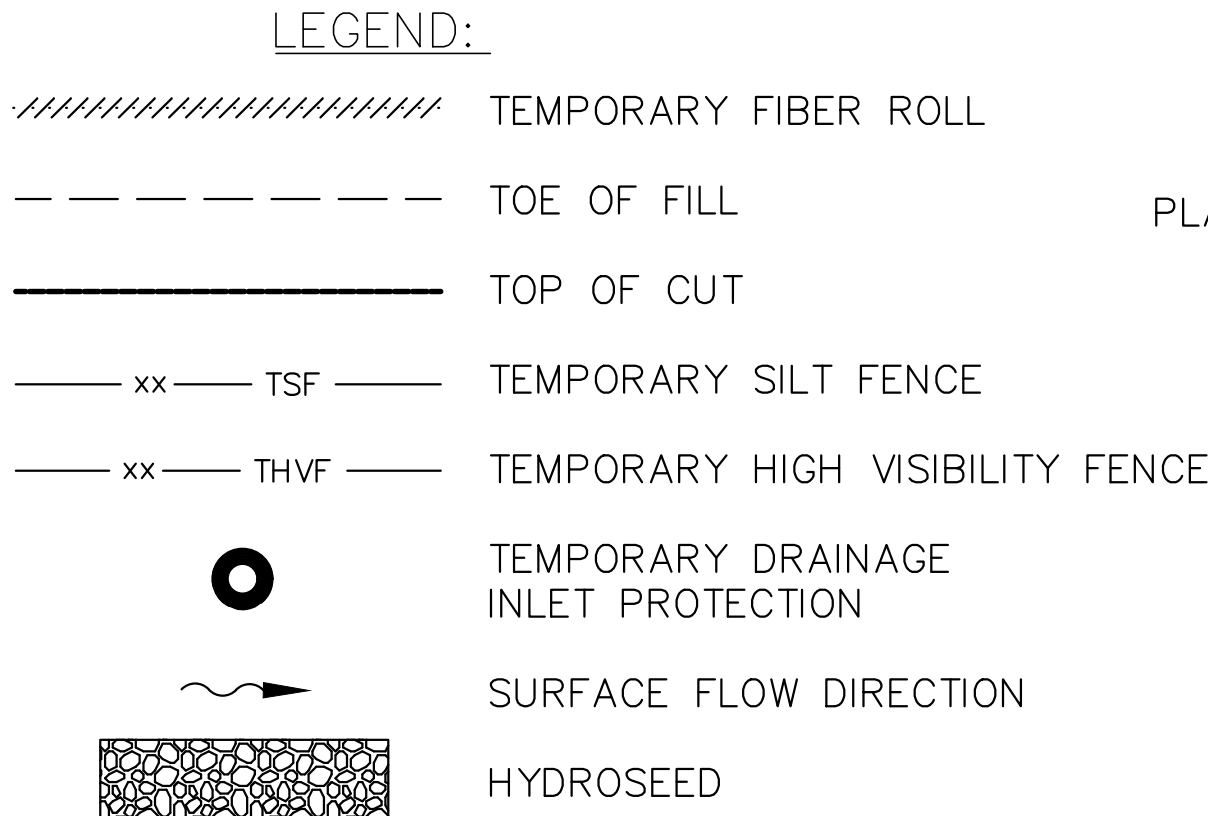
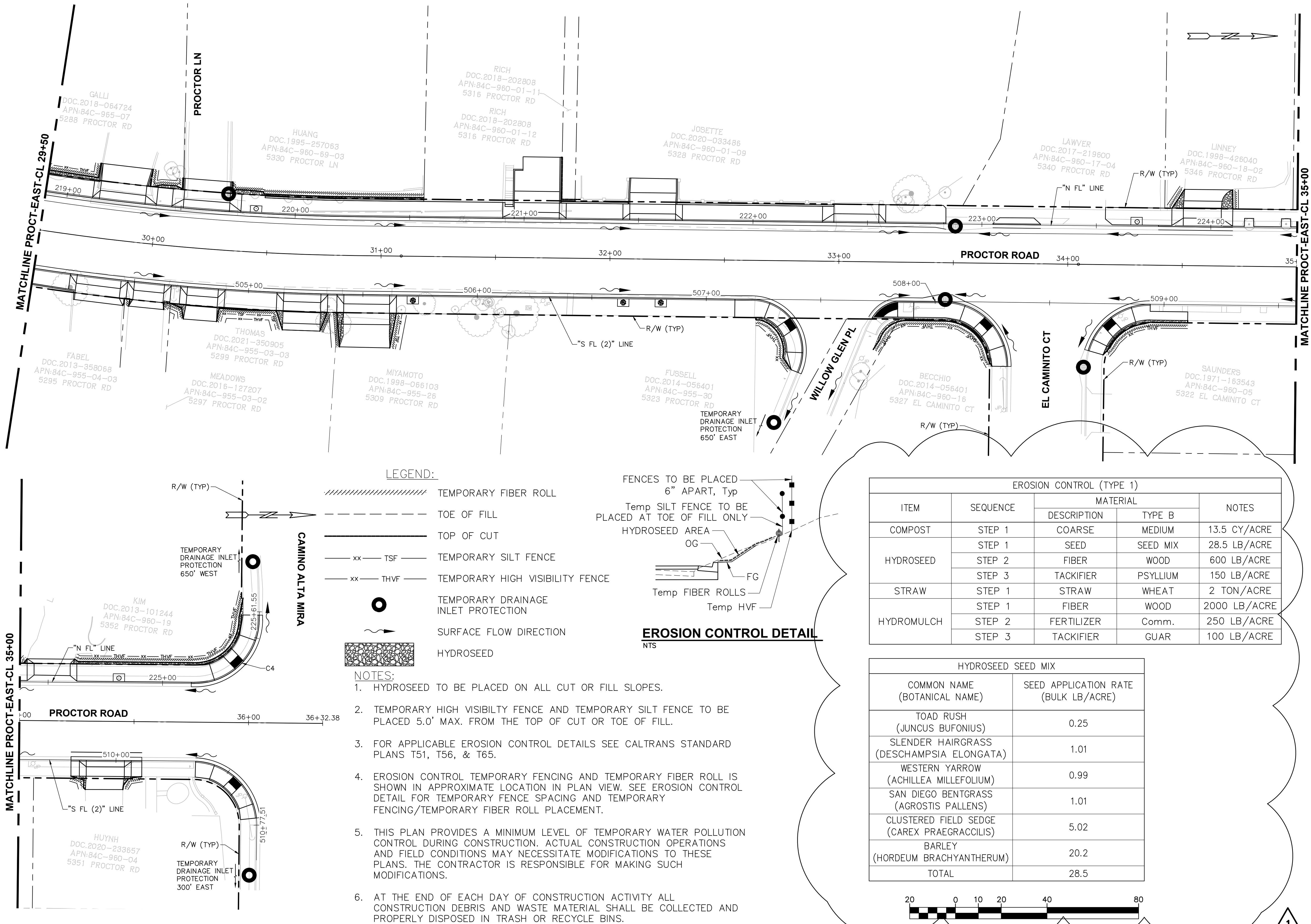

EROSION CONTROL (TYPE 1)				
ITEM	SEQUENCE	MATERIAL		NOTES
		DESCRIPTION	TYPE B	
COMPOST	STEP 1	COARSE	MEDIUM	13.5 CY/ACRE
	STEP 2	SEED	SEED MIX	28.5 LB/ACRE
	STEP 3	FIBER	WOOD	600 LB/ACRE
HYDROSEED	STEP 1	TACKIFIER	PSYLLIUM	150 LB/ACRE
	STEP 2	STRAW	WHEAT	2 TON/ACRE
	STEP 3	FIBER	WOOD	2000 LB/ACRE
HYDROMULCH	STEP 1	FIBER	WOOD	2000 LB/ACRE
	STEP 2	FERTILIZER	Comm.	250 LB/ACRE
	STEP 3	TACKIFIER	GUAR	100 LB/ACRE

HYDROSEED SEED MIX	
COMMON NAME (BOTANICAL NAME)	SEED APPLICATION RATE (BULK LB/ACRE)
TOAD RUSH (JUNCUS BUFONIUS)	0.25
SLENDER HAIRGRASS (DESCHAMPSIA ELONGATA)	1.01
WESTERN YARROW (ACHILLEA MILLEFOLIUM)	0.99
SAN DIEGO BENTGRASS (AGROSTIS PALLENS)	1.01
CLUSTERED FIELD SEDGE (CAREX PRAEGRACCLIS)	5.02
BARLEY (HORDEUM BRACHYANTHERUM)	20.2
TOTAL	28.5

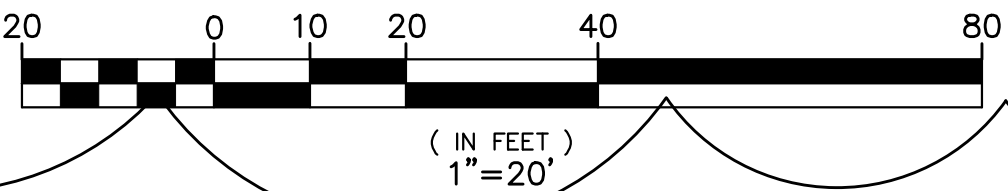

- NOTES:**
- HYDROSEED TO BE PLACED ON ALL CUT OR FILL SLOPES.
 - TEMPORARY HIGH VISIBLTY FENCE AND TEMPORARY SILT FENCE TO BE PLACED 5.0' MAX. FROM THE TOP OF CUT OR TOE OF FILL.
 - FOR APPLICABLE EROSION CONTROL DETAILS SEE CALTRANS STANDARD PLANS T51, T56, & T65.
 - EROSION CONTROL TEMPORARY FENCING AND TEMPORARY FIBER ROLL IS SHOWN IN APPROXIMATE LOCATION IN PLAN VIEW. SEE EROSION CONTROL DETAIL FOR TEMPORARY FENCE SPACING AND TEMPORARY FENCING/TEMPORARY FIBER ROLL PLACEMENT.
 - THIS PLAN PROVIDES A MINIMUM LEVEL OF TEMPORARY WATER POLLUTION CONTROL DURING CONSTRUCTION. ACTUAL CONSTRUCTION OPERATIONS AND FIELD CONDITIONS MAY NECESSITATE MODIFICATIONS TO THESE PLANS. THE CONTRACTOR IS RESPONSIBLE FOR MAKING SUCH MODIFICATIONS.
 - AT THE END OF EACH DAY OF CONSTRUCTION ACTIVITY ALL CONSTRUCTION DEBRIS AND WASTE MATERIAL SHALL BE COLLECTED AND PROPERLY DISPOSED IN TRASH OR RECYCLE BINS.

REVISIONS

NO.	DESCRIPTION	BY	DATE

APPROVED

PROFESSIONAL ENGINEER
JAMES CLEMENTS
No. C4757
DATE OF EXPIRATION
03-07-25

consor

344 Thomas L. Braylor Way
Oakland, California 94612
(415) 543-8515

CHECKED: CAROLYN DAVIS
DESIGNED: AMBER K. LO
APPROVED: DERRICK LEAHY
JAMES CLEMENTS

COUNTY OF ALAMEDA ☆ PUBLIC WORKS AGENCY

THE IMPROVEMENTS OF
PROCTOR ROAD
FROM REDWOOD ROAD TO CAMINO ALTA MIRA
STORM WATER POLLUTION
PREVENTION PLAN

REVIEWED: EMANUEL KASENE
REVIEWED: JESSIE PAN
APPROVAL RECOMMENDED:
AMBER K. LO

DATE: MAR 2025
SCALE: 1"=20'
WORK ORDER NO.: R32144
SPECIFICATION NO.: 2491
SHEET NO.: 04 OF 59
FILE NO.: U-639